

D.1.1.01 1.S FLOOR PLAN

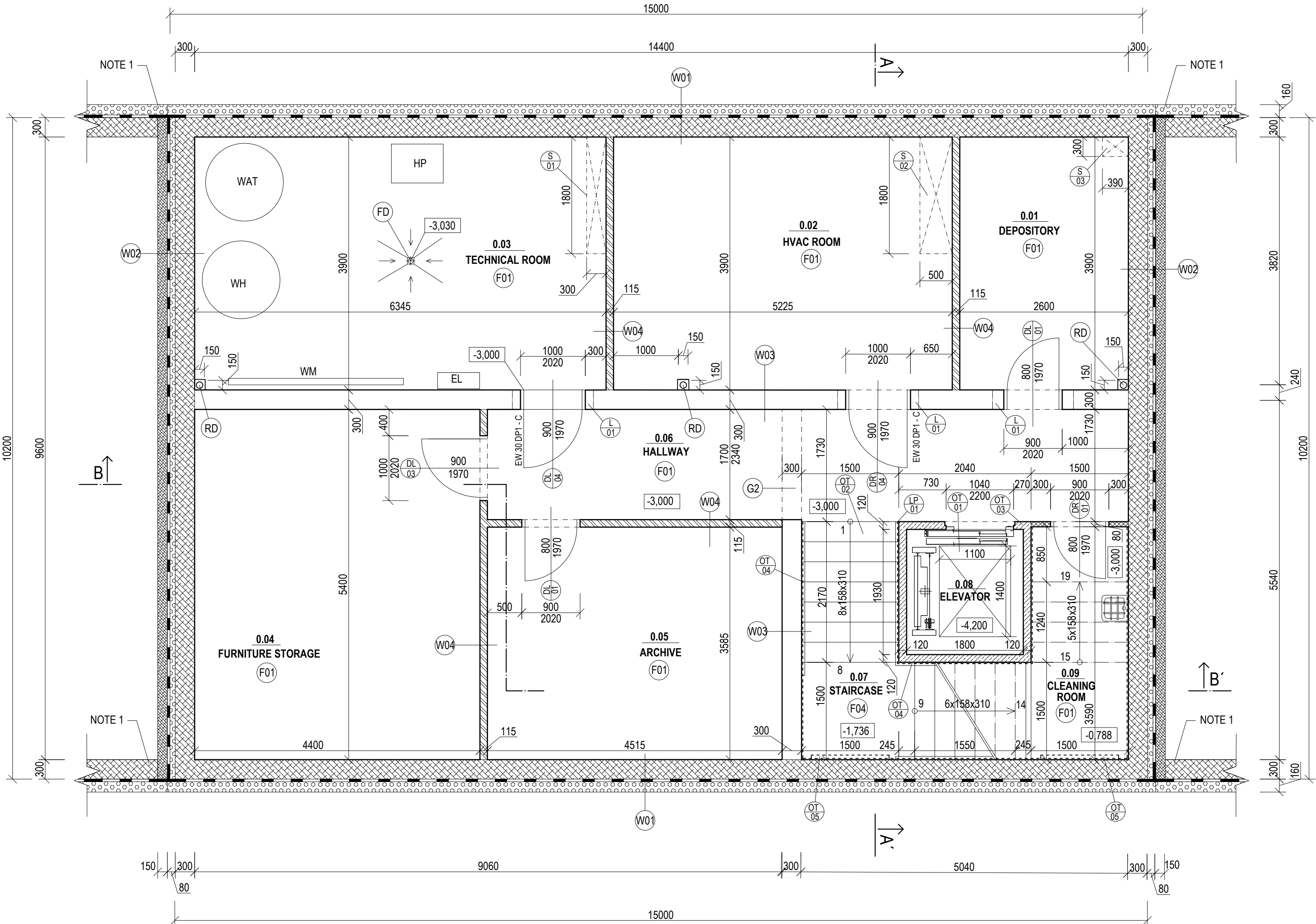

SCHEDULE OF ROOMS:

NUMNBER	NAME OF THE ROOM	AREA (m2)	CLEAR HEIGHT (mm)	FLOOR FINISH	WALL FINISH	CEILING FINISH	NOTES
0.01	DEPOSITORY	10.14	2640	EPOXY COATING	LIME-CEMENT CORE PLASTER WITH STUCCO PLASTER th.15mm	SPIROLL PANEL + ACRYLATE PAINT	STAINELSS STEEL PLINTH PROFILE, th.100mm
0.02	HVAC ROOM	20.38	2640	EPOXY COATING	LIME-CEMENT CORE PLASTER WITH STUCCO PLASTER th.15mm	SPIROLL PANEL + ACRYLATE PAINT	STAINELSS STEEL PLINTH PROFILE, th.100mm
0.03	TECHNICAL ROOM	24.74	2640	EPOXY COATING	LIME-CEMENT CORE PLASTER WITH STUCCO PLASTER th.15mm	SPIROLL PANEL + ACRYLATE PAINT	STAINELSS STEEL PLINTH PROFILE, th.100mm
0.04	FURNITURE STORAGE	23.92	2640	EPOXY COATING	LIME-CEMENT CORE PLASTER WITH STUCCO PLASTER th.15mm	SPIROLL PANEL + ACRYLATE PAINT	STAINELSS STEEL PLINTH PROFILE, th.100mm
0.05	ARCHIVE	16.19	2640	EPOXY COATING	LIME-CEMENT CORE PLASTER WITH STUCCO PLASTER th.15mm	SPIROLL PANEL + ACRYLATE PAINT	STAINELSS STEEL PLINTH PROFILE, th.100mm
0.06	HALLWAY	16.90	2640	EPOXY COATING	LIME-CEMENT CORE PLASTER WITH STUCCO PLASTER th.15mm	SPIROLL PANEL + ACRYLATE PAINT	STAINELSS STEEL PLINTH PROFILE, th.100mm
0.07	STAIRCASE	13.95	2640	ANTISLIP PAINT	LIME-CEMENT CORE PLASTER WITH STUCCO PLASTER th.15mm	SPIROLL PANEL + ACRYLATE PAINT	STAINELSS STEEL PLINTH PROFILE, th.100mm
0.08	ELEVATOR	3.47	-	-	-	-	-
0.09	CLEANING ROOM	5.38	2640	EPOXY COATING	LIME-CEMENT CORE PLASTER WITH STUCCO PLASTER th.15mm	SPIROLL PANEL + ACRYLATE PAINT	STAINELSS STEEL PLINTH PROFILE, th.100mm
SUM OF AREAS		135.09					

SCHEDULE OF LINTELS AND GIRDERS:

SYMBOL	NAME OF THE LINTEL	SCHEME	DIMENSIONS WxHxL (mm)	MIN. OVERLAP (mm)	No. OF ELEMENTS PER 1 ASSEMBLY	No. OF ASSEMBLIES	TOTAL No. OF ELEMENTS
L 01	CERAMIC LINTEL KP 7	[Symbol]	70x238x1250	125	4	3	12
G2	RFC GIRDER, PART OF RFC RING	[Symbol]	300x300x1700	-	1	1	1

LEGEND OF TZB SYMBOLS:

- WH WATER HEATER
- WAT WATER ACCUMULATION TANK
- EL ELECTRICITY METER AND DISTRIBUTION BOX
- WM WATER METER
- HP GEOTHERMAL HEAT PUPM, GROUND-WATER SOURCE

NOTES:

- DIMENSIONING IS DONE IN COORDINATION / MODULAR DIMENSIONS
- DETAILS ABOUT MATERIALS AND COMPOSITIONS ARE IN LIST OF COMPOSITIONS
- DETAILS ABOUT ELEMENTS ARE IN LIST OF ELEMENTS
- ELEVATOR WILL BE DESIGNED IN SEPARATE PROJECT DOCUMENTATION (NOT PART OF THIS WORK)
- ELEVATOR SHAFT AND STAIRCASE ARE PREFABRICATED, STAIRCASE IS ACOUSTICALLY SEPARATED FROM OTHER LOAD-BEARING STRUCTURES BY SHOCK SYSTEM
- STAIRCASE HALF-LANDING IS PLACED ONTO L PROFILE SECURED BY CHEMICAL ANCHORS
- STAIRCASE IS DILATED FROM OTHER STRUCTURES BY 25mm THICK DILATATION GAP FILLED WITH SYLOMER MAT AGAINST IMPACT SOUND, SYLOMER MAT IS ALSO ON PARTS WHERE STAIRCASE MEETS WITH SLAB/LANDING
- ALL REINFORCED CONCRETE ELEMENTS WILL BE DESIGNED ACC TO STRUCTURAL DESIGN DESIGNED BY CHARTERED ENGINEER (NOT PAR OF THIS WORK)
- PASSAGES OF ENGINEERING NETWORKS WILL BE DONE ACC. TO PART D.1.4 BUILDING TECHNICAL SOLUTION (NOT PART OF THIS WORK) IN CASE THEY ARE PASSING THROUGH FIRE DEPARTMENTS, THEY WILL BE PROPERLY FIRE-SEALED ACC TO D.1.3 FIRE SAFETY - TECHNICAL REPORT
- WATERPROOFING AND PLINTH INSULATION XPS, WILL BE MIN 300mm ABOVE SURROUNDING TERRAIN
- WALL CONNECTIONS WILL BE MADE BY WALL TIES cca 20mm UNDER CEILNIG STRUCTURE, GAP FILLED WITH PU FOAM
- BEFORE INSTALLATION OF DOORS AND WINDOWS, CONSTRUCTED OPENINGS ON SITE HAVE TO MEASURED
- WHEN INSTALLING LINTELS MIN. OVERLAPS WILL BE KEPT
- LINTELS WILL BE PLACED ONTO CEMENT BED 10mm THICK
- VENTILATION WILL BE ENSURED BY MECHANICAL VENTILATION
- ALL EXTERNAL FACADES WILL COMPLY WITH ETICS SYSTEM STANDARDS
- DURING ALL CONSTRUCTION WORKS IT IS IMPORTANT TO FOLLOW LEGAL REGULATION, NORMS, TECHNOLOGICAL PROCEDURES AND BOZP

LEGEND OF MATERIALS:

- [Symbol] LOAD-BEARING FORMWORK BLOCKS BTB 50/30/25 (P+D), LxWxH 500x300x250mm, FILLED WITH REINFORCED CONCRETE C20/25, STEEL B500B DESIGNED ACCORDING TO STRUCTURAL DESIGN (NOT PART OF THIS PD), REI 180 DP1
- [Symbol] SUPPORTING WALL FROM FORMWORK BLOCKS BTB 50/15/25 (P+D), LxWxH 500x150x250mm, FILLED WITH REINFORCED CONCRETE C20/25, STEEL B500B DESIGNED ACCORDING TO STRUCTURAL DESIGN (NOT PART OF THIS PD), REI 180 DP1
- [Symbol] LOAD-BEARING WALL FROM CERAMIC BLOCKS POROTHERM 30 PROFI, th. 300mm, LxWxH 247x300x249mm, LAID ON THIN MORTAR JOINT, Rw=48dB, REI 180 DP1
- [Symbol] PARTITION WALL FROM CERAMIC BLOCKS POROTHERM 11.5 PROFI, th. 115mm, LxWxH 497x115x249mm, LAID ON THIN MORTAR JOINT, Rw=43dB, EI 120 DP1
- [Symbol] PEFABRICATED ELEVATOR SHAFT, th. 120mm, REINFORCED CONCRETE C35/45 XC2, STEEL B500B DESIGNED ACCORDING TO STRUCTURAL DESIGN (NOT PART OF THIS PD), REI 180 DP1
- [Symbol] THERMAL INSULATION FROM EXTRUDED POLYSTYRENE, XPS 300 L, th. 80mm AND th. 160m, STRENGTH 300 kPa, $\lambda_g=0.033$ W/mK
- [Symbol] WATERPROOFING - 2x SBS MODIFIED ASPHALT FELT WITH GLASS FIBRE, th. 2x4mm
- [Symbol] SURROUNDING SOIL - WITHOUT DISTINGUISHING ORIGINAL TERRAIN / EMBANKMENT

LEGEND OF SYMBOLS:

- W0x WALL COMPOSITION, SEE LIST OF COMPOSITIONS
- F0x FLOOR COMPOSITION, SEE LIST OF COMPOSITIONS
- C0x CEILING COMPOSITION, SEE LIST OF COMPOSITIONS
- G 0x GIRDER, SEE LEGEND OF LINTELS
- L 0x LINTEL, SEE LEGEND OF LINTELS
- DL 0x INTERNAL LEFT-HANDED DOORS, SEE LIST OF ELEMENTS
- DR 0x INTERNAL RIGHT-HANDED DOORS, SEE LIST OF ELEMENTS
- CP 0x CARPENTRY PRODUCTS, SEE LIST OF ELEMENTS
- TP 0x TINSMITH PRODUCTS, SEE LIST OF ELEMENTS
- LP 0x LOCKSMITH PRODUCTS, SEE LIST OF ELEMENTS
- O 0x EXTERNAL OPENING, SEE LIST OF ELEMENTS
- S 01 INSTALLATION SHAFT, INTERNAL DIMENSIONS 1800x500mm
- S 02 INSTALLATION SHAFT, INTERNAL DIMENSIONS 1800x300mm
- S 03 INSTALLATION SHAFT, INTERNAL DIMENSIONS 300x390mm
- RD RAINWATER DRAIN PIPE 150X150, DN100, DILATED BY MINERAL WOOL 25mm, COVERED BY PLASTERBOARD 12.5mm, SEE LIST OF ELEMENTS
- FD 01 FLOOR DRAIN DN100 WITH STAINLESS STEEL GRID 150x150mm, MIN. SLOPE 1%, SEE LIST OF ELEMENTS
- IN 0x PASSAGE OF ENGINEERING NETWORKS
- OT 01 ELECTRIC ELEVATOR KONE MONOSPACE 300 DX, WITHOUT MACHINE ROOM, CABIN DIMENSIONS 1400x1100mm, HEIGHT OF CABIN 2100mm, SEE LIST OF ELEMENTS
- OT 02 PREFABRICATED STAIRCASE, SEE LIST OF ELMENTS
- OT 03 PREFABRICATED ELEVATOR SHAFT, DIMENSIONS 2040x2170mm, WALL THICK. 120mm, SEE LIST OF ELEMENTS
- OT 04 STAIRCASE DILATATION GAP 25mm FILLED WITH IMPACT SOUND INSULATION, SYLOMER MAT
- OT 05 CHEMICAL ANCHOR AND LOAD-BEARING L PROFILE WITH IMPACT SOUND INSULATION, SEE LIST OF ELEMENTS

NOTE 1 SEE DRAWING OF FOUNDATION

0,000 =240,24		m.a.s.l., B.H.S. / COORDINATE SYSTEM S-JTSK			
COURSE	DIPLOMA THESIS				FAKULTA STAVEBNÍ stavby pozemního stavatelství
DRAWN BY	BARBORA HUSÁROVÁ				
SUPERVISED BY	ING. JAN MÜLLER PH.D.				
INVESTOR					
LOCATION	POŘADÍ, 687 51 NIVNICE, PARCELS No. 65, 64, 63, 61, 57				
PROJECT TITLE	MUNICIPAL CENTRE IN NIVNICE				
BUILDING OBJECT	BO 01 MUNICIPAL CENTRE			PAPER FORMAT	850x420
PART	D.1.1 ARCHITECTURAL BUILDING SOLUTION			DATE	01/2025
DRAWING TITLE:				PROJ. PHASE	DPS
BASEMENT FLOOR PLAN				SCALE	DRAWING NO.
				1:50	D.1.1.01